

Breakout 3  
Resilience  
through Art

Breakout 4  
AWARE

Breakout 5  
Nock Lab

Speaker  
Green  
Room

Self-Care  
Room  
(avail. all day)

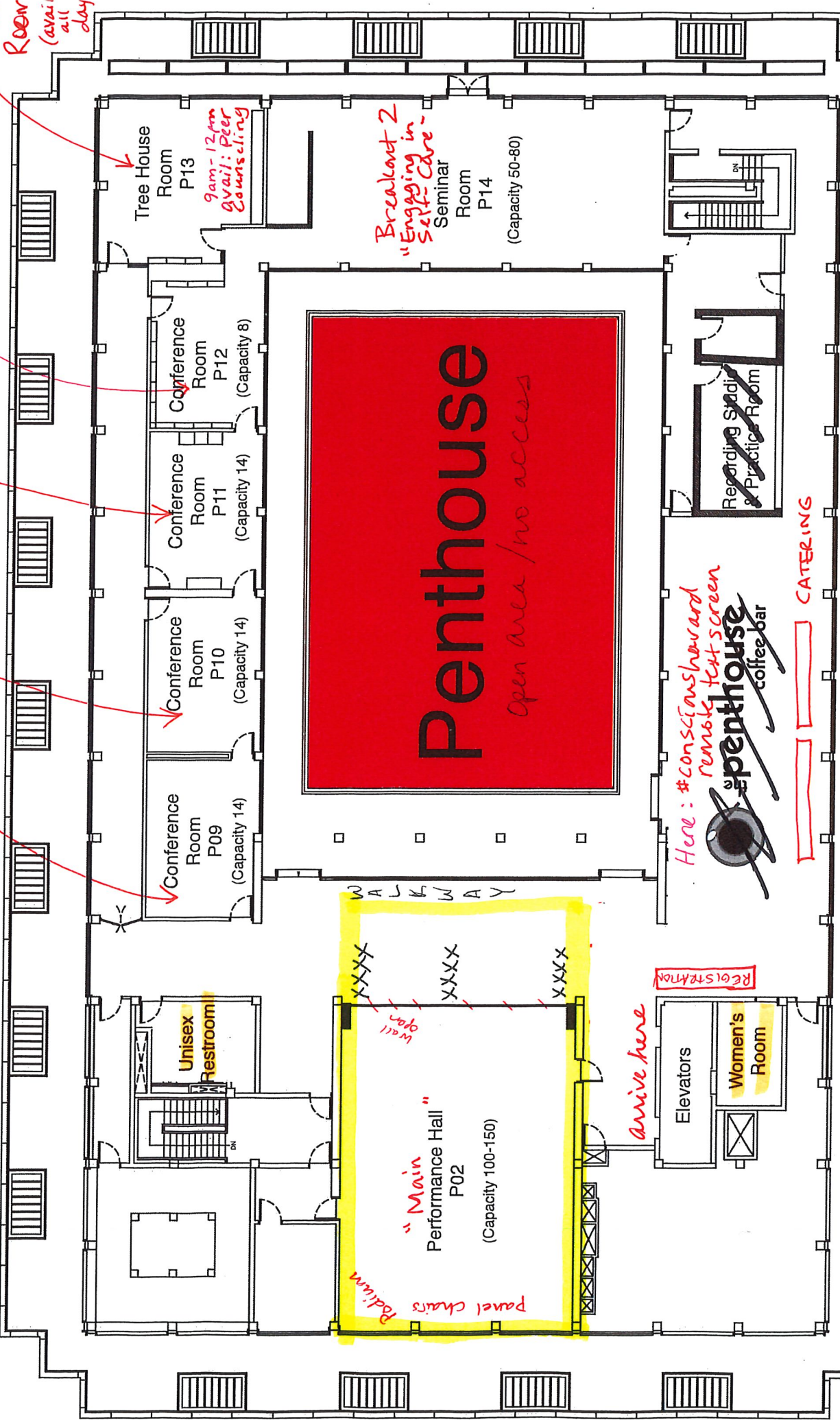

Tree House Room P13  
9am-12pm  
avail: Peer  
Counseling

Breakout 2  
"Engaging in  
Self-Care"  
Seminar Room P14  
(Capacity 50-80)

**Penthouse**  
open area / no access

Conference Room P12  
(Capacity 8)

Conference Room P11  
(Capacity 14)

Conference Room P10  
(Capacity 14)

Conference Room P09  
(Capacity 14)

Recording Studio & Practice Room

Here: #consciousward  
remote text screen  
penthouse  
coffee bar

CATERING

WALKWAY

Panel chairs podium

XXXX  
XXXX  
XXX

Wall open

"Main Performance Hall"  
P02  
(Capacity 100-150)

arrive here

RESTRICTION

Elevators  
Women's Room

Unisex Restroom